

# Mountain Brook Schools

## Apple TV Configuration

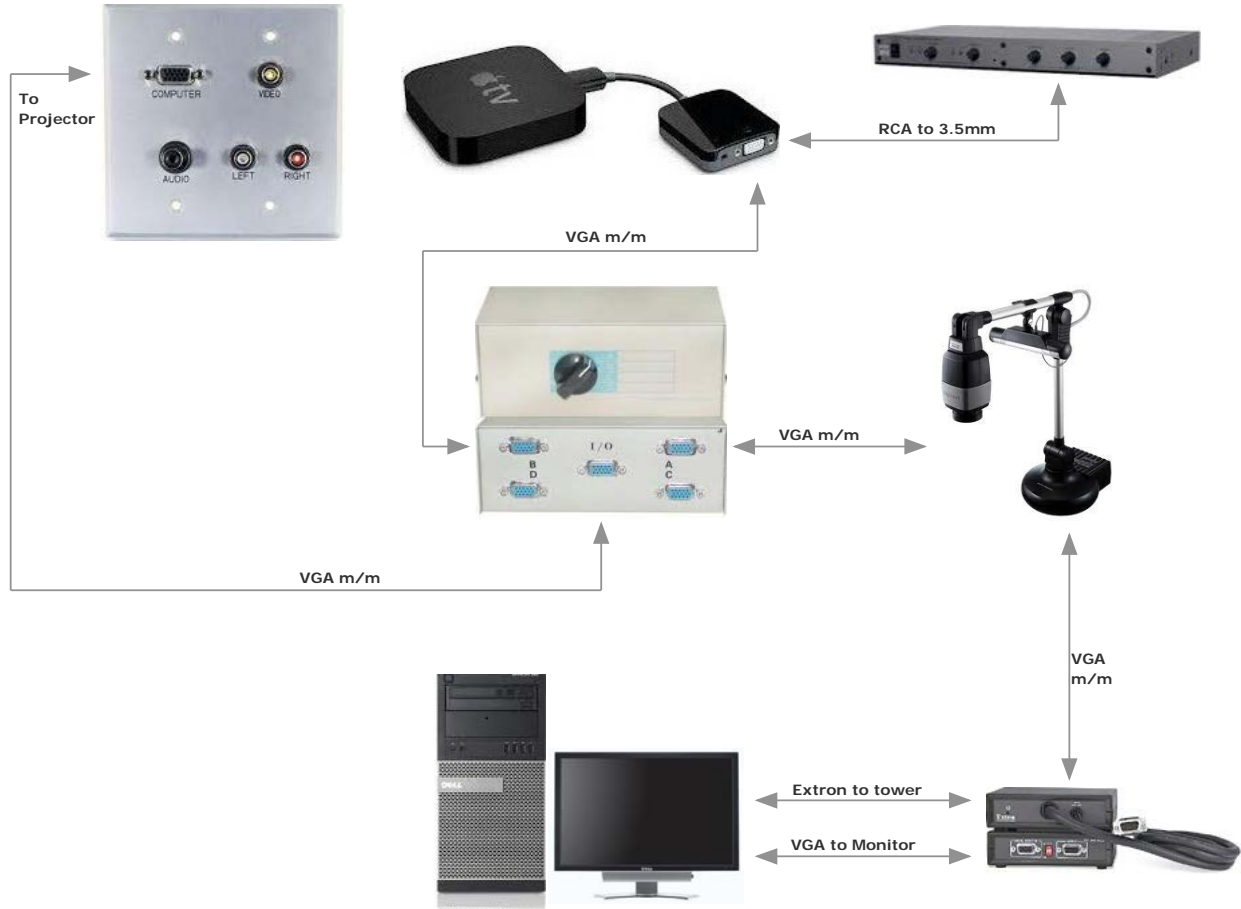

### Parts List

Apple TV	Apple Store	\$99.00
Kanex-ATV-Pro HDMI to VGA adapter with audio	Apple store	\$59.95
4 – Port VGA Manual Switch Box	Monoprice.com	\$11.65
1.5ft svga cable	Monoprice.com	\$02.28
6ft 3.5mm stereo plug / RCA Plug Cable	Monoprice.com	<u>\$00.76</u>

Est.: **\$175.00**

*\*Must have available network jack for constant connectivity.*

### Network Configuration

1. Configure the Apple TV with a static IP address. See District Tech Office for address.
2. Connect to the network via hardwire into an Ethernet Jack.
3. Plug the network cable for the Apple TV into a network port in the wiring closet that is configured to be on the same VLAN as the Apple devices.